

Site Description

Lot 2 & Part Lot 1 DP9298 and Part Lot 2 DP 9031
 Maori Park
 Cnr Te Weka St & Benvenue Ave
 Timaru 7910
 Owner: Timaru District Council

Notes

Refer Structex drawings & specification for site civil & drainage works
 Refer Boffa Miskell drawings & specification for landscaping works
 Refer Architectural SWP drawings for external works to building

Rev	Date	Description

ISSUED FOR:
Tender & Bldg Consent
16.06.10

BOON GOLDSMITH BHASKAR BREBNER
team architects
 Boon Goldsmith Bhaskar Brebner Team Architects Ltd
 131 Courtenay Street New Plymouth 4310 New Zealand
 t. +64 6 757 3200 f. +64 6 758 1344
 office@bgb-ta.co.nz www.teamarchitecture.co.nz
WOMAD
 Proud to be an event sponsor of

Job Title
Caroline Bay AQUATIC CENTRE
 Te Weka Street Timaru
 for Timaru District Council

Architect	Checked	Drawn	Date
GB	--	--	Nov 2009

Drawing Title
Site Setout Plan

Scale [A3]	Job No.	Drawing No.	Rev.	Print Date
1:500	5302	A1.01	0	14.06.10

ALL CONTRACTORS MUST VERIFY ALL DIMENSIONS ON THE JOB BEFORE COMMENCING ANY WORK. DO NOT SCALE. © COPYRIGHT ON THESE DRAWINGS IS RESERVED.

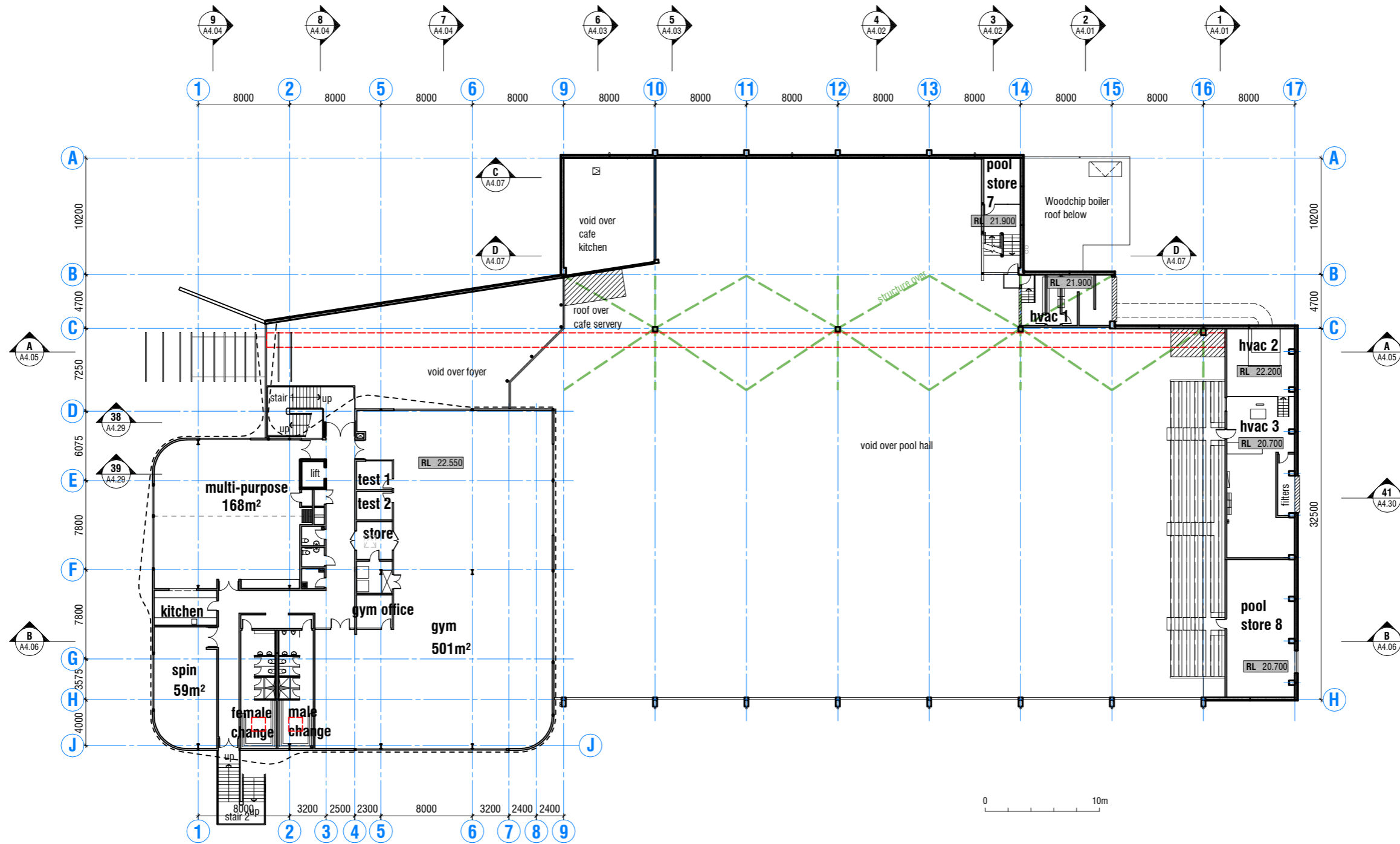

Rev	Date	Description

ISSUED FOR:
Tender & Bldg Consent
16.06.10

BOON GOLDSMITH BHASKAR BREBNER
team architects
 Boon Goldsmith Bhaskar Brebner Team Architects Ltd
 131 Courtenay Street New Plymouth 4310 New Zealand
 t. +64 6 757 3200 f. +64 6 758 1344
 office@bgb-ta.co.nz www.teamarchitecture.co.nz

Job Title

Caroline Bay
 AQUATIC CENTRE
 Te Weka Street Timaru
 for Timaru District Council

Architect	Checked	Drawn	Date
GB	--	--	Nov 2009

Drawing Title
First Floor Plan

Scale [A3]	Job No.	Drawing No.	Rev.	Print Date
1:400	5302	A2.02	0	15.06.10

ALL CONTRACTORS MUST VERIFY ALL DIMENSIONS ON THE JOB BEFORE COMMENCING ANY WORK. DO NOT SCALE. © COPYRIGHT ON THESE DRAWINGS IS RESERVED.