



APPLICATION FOR RESIDENTIAL BUILDING CONSENT FOR SOLID/LIQUID FUEL HEATING APPLIANCE

BA Form 2H

Version 2

December 2007

Send or deliver your application to:
Building Advisory Services, Timaru District Council,
2 King George Place, P O Box 522, Timaru

Telephone: (03) 687 7200
Fax: (03) 687 7209
Email: building@timdc.govt.nz
Web: www.timaru.govt.nz

Application No:

A THE BUILDING *(Project Location)*

Street or road address of building:
.....
.....
.....
.....
.....

Legal description of land where building is located: *(state legal description as at the date of application and, if the land is proposed to be subdivided, include details of relevant lot numbers and subdivision consent)*

Valuation number:

Zone:

Lot: **DP:**

Section:

Building name: *(if applicable)*
.....
.....

Location of building within site: *(include nearest street access)*
.....
.....

Number of levels: *(include ground level and any levels below ground)*
.....

Level/Unit Number: *(if applicable)*
.....

Area: *total floor area (indicate area affected by the building work if less than the total area)*
.....

Current, lawfully established, use: *(include number of occupants per level and per use if more than 1 level)*
.....

Year first constructed: *(insert year, approximate date is acceptable eg 1920s or 1960-1970)*

Date Stamp - Office Use

B THE OWNER

Name of owner: *(include preferred form of title, eg, Mr, Miss, Dr, if an individual)*

Contact person: *(only required if different from owner)*

Mailing address:
.....
.....

Street address/Registered office:
.....
.....

Contact details:

Landline number:

Mobile number:

Daytime number:

After hours number:

Facsimile number:

Email address:

Please attach one of the following as evidence of ownership to this application:

- copy of certificate of title, lease, agreement for sale and purchase, or other document showing full name of legal owner(s) of the building.

APPLICATIONS WILL NOT BE ACCEPTED WITH INCOMPLETE DOCUMENTATION

C AGENT*(Only required if application is being made on behalf of the owner, delete if not applicable)*

Name of agent:

Contact person:

Mailing address:

Street address/Registered office:

Contact details:

Landline number: Mobile number:
 Daytime number: After hours number:
 Facsimile number: Email address:

Relationship to owner: *(state details of the authorisation from the owner to make the application on the owner's behalf)*

First point of contact: *(state full name, mailing address, phone numbers and email address)*

Name of contact:
 Mailing address:
 Landline number: Mobile number:
 Daytime number: After hours number:
 Facsimile number: Email address:

D THE APPLICATION

I request that you issue a Project Information Memorandum Building Consent for the building work described in this application (tick one or both, if a Project Information Memorandum has not already been obtained).

Signed by the owner, OR

Signature:
 Name:
 Date:

Signed by the agent *(on behalf of, or with authority from, the owner)*

Signature:
 Name:
 Date:

E THE PROJECT**INSTALLATION OF A SOLID FUEL/LIQUID FUEL APPLIANCE**

Make:
 Model:
 New Model Second Hand Model
 Inbuilt Free Standing Wetback
 Fuel: Wood Multifuel Pellets Diesel
 Clean Air Certification No:
 Is this heater replacing an existing heater: Yes No
 If yes, make/model it is replacing:.....

Installer:
 Address:

 If installation includes a wetback state craftsman plumbers details:
 Name *(individual)*:
 Address:

F SITE PLANS

COMPLETE SITE PLAN ON PAGE 4 (1 SQUARE = 1 SQUARE METRE), OR ALTERNATIVELY SUPPLY TWO SETS OF WORKING DRAWINGS (PREFERABLY ON A3). PLANS ARE TO BE CLEAR, IN INK AND BLACK LINEWORK ON A WHITE BACKGROUND, WITH A SCALE OF 1:100 (OR 1:200 FOR SECTIONS LARGER THAN 1500M²). PROVIDE ACCURATE DIMENSIONS.

	Applicant	Council	Comment
Locate position of flue	<input type="checkbox"/>	<input type="checkbox"/>	
Identify distance to neighbouring property	<input type="checkbox"/>	<input type="checkbox"/>	

APPLICATIONS WILL NOT BE ACCEPTED WITH INCOMPLETE DOCUMENTATION

G APPLICATION CHECKLIST			
	Applicant	Council	Comment
PIM Form (if applicable)	<input type="checkbox"/>	<input type="checkbox"/>	
Resource Consent (if applicable)	<input type="checkbox"/>	<input type="checkbox"/>	

H FREESTANDING/INBUILT FIRES			
PLEASE PROVIDE ON PAGE 4			
	Applicant	Council	Comment
a Floor plan (not less than 1:100) with 1 square = 1 square metre showing <ul style="list-style-type: none"> Location of neighbouring property and distance between both properties Location of the solid fuel appliance in the dwelling, including proximity to any windows. If flue extends through or past a second storey, plans of the upper storeys are also required. 	<input type="checkbox"/>	<input type="checkbox"/>	
b Liquid fuel storage <ul style="list-style-type: none"> Show type of fuel (eg diesel, home blend, kerosene), size and location of the fuel storage tank related to the building and site boundaries. Wall openings (windows or doors) and wall cladding material within one metre of the storage tank vicinity should be shown (including neighbouring properties). Identify type of fuel (eg diesel, home blend, kerosene). Show the location of the existing water heater if a wet back/hot water booster fitted is to be. Location and type of smoke detectors. 	<input type="checkbox"/>	<input type="checkbox"/>	
c Manufacturer's specifications <ul style="list-style-type: none"> For correct installation and use of the solid fuel appliance. The specifications must relate to the specific make and model of fire being installed. Alternatively state the generic standard being installed. Must be available at time of inspection. 	<input type="checkbox"/>	<input type="checkbox"/>	
d Flue details <ul style="list-style-type: none"> Where these are not included in the manufacturer's specifications. 	<input type="checkbox"/>	<input type="checkbox"/>	
e Weatherproofing details <ul style="list-style-type: none"> Flashing details for the flue penetrations. 	<input type="checkbox"/>	<input type="checkbox"/>	
f Secondhand appliances must have an acceptable Producer Statement <ul style="list-style-type: none"> Producer statements must be from manufacturer or approved installer, be on firm's letterhead, state the residual durability of both the appliance and/or the flue, and be signed and dated. A new inner flue is required in all cases. 	<input type="checkbox"/>	<input type="checkbox"/>	

I ADVISORY NOTES FOR SOLID FUEL HEATERS	
All Heaters Building Consent required Installed to Manufacturer's Installation Instructions Inspection by Council Code Compliance Certificate	IMPORTANT NOTE: Environment Canterbury rules relating to solid fuel heaters require that only low emission wood burners or pellet fires currently listed on the Mfe website, be installed on any property smaller than 2 hectares. Any enquires re solid fuel heaters and their emissions should be referred to: Environment Canterbury - Free Phone 0800 32 4636
Wet backs connected to Hot Water Cylinder and Heat Tempering Valve by Craftsman Plumber Note: Council cannot assist with installation instructions	
Approved Installers: <ul style="list-style-type: none"> - Dan Cosgrove Ltd - Menzies Group - Timaru Plumbing & Gas - Steve Laws 	<ul style="list-style-type: none"> - Aitken Plumbing - Wilson & Robinson - Ray Taylor - Temuka Plumbing & Gas - Jack Rate - John Shaw
<div style="border: 1px solid black; padding: 5px;"> Disclaimer Advisory notes are issued on a no-liability basis. They are to assist Council customers to meet compliance issues. </div>	

APPLICATIONS WILL NOT BE ACCEPTED WITH INCOMPLETE DOCUMENTATION

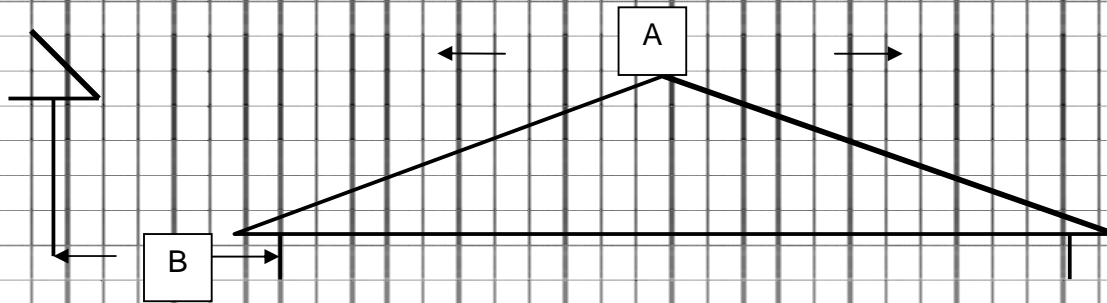

Step 1 Locate position of flue; in relation to ridge line.

Step 2 Identify distance from flue to ridge this is measurement "A".

Step 3 Identify distance from neighbouring structure to your own property "B".

FLOOR PLAN

APPLICATIONS WILL NOT BE ACCEPTED WITH INCOMPLETE DOCUMENTATION