

EXISTING EASEMENTS			
NATURE	SERVIENT TEN LOT NO SHOWN		DOCUMENT
RIGHT TO DRAIN SEWAGE	2	K, U	Deed of Easement 45A/687
	4	E, V	
	5	H, W, X	
	7	Y	
RIGHT OF WAY (IN (GROSS) FOR PURPOSES OF CONSERVATION MANAGEMENT AND RIGHT OF WAY (IN (GROSS) FOR PUBLIC ACCESS	2	M	EI 7584791.3
RIGHT (IN GROSS) TO CONVEY ELECTRICITY	7	AA, AB	EI 9906693.2

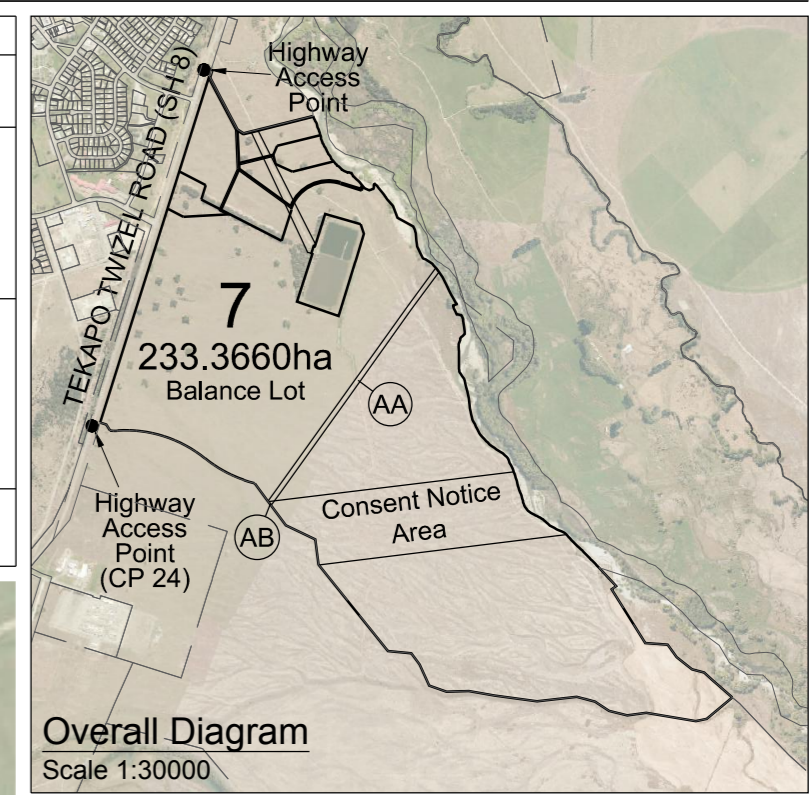

Address: Tekapo-Twizel Road (SH 8), Canterbury

Lot 1 DP 422901
Comprised In - CT 489340
Owners - High Country Rosehip Orchards Limited
Area - 246.1960ha

Areas and dimensions are subject to survey.
A full assessment of easements will be undertaken after the engineering is complete. This may result in additional easements.

Boundaries, easements and '300m line to Sewage Pond' scaled and aligned from **vivian+espie** plans (ref. 1119 PLP1 - 23.05.2016).

Areas A, J, K, L, & M will be subject to a Land Covenant.

Lot 1 DP 422901 is subject to Part IVA Conservation Act 1987, a Land Covenant in Easement Instrument 9906693.4 and Consent Notice 9877186.4.

MEMORANDUM OF EASEMENTS			
NATURE	SERVIENT TEN LOT NO SHOWN	DOMINANT TENEMENT	
RIGHT OF WAY, RIGHT TO DRAIN SEWAGE & STORMWATER, RIGHT TO CONVEY WATER, ELECTRICITY & TELECOMMUNICATIONS	1	A, B, C	Lots 2-6
	4	D, E, F	Lot 3
RIGHT OF WAY	1	A, B	Section 1 SO 18355
	5	G, H	Lot 2 DP 422901
	1	A, B, C	
	5	G, H	
	6	I	
RIGHT TO CONVEY ELECTRICITY IN GROSS	Lot 2 DP 422901	AB	Lots 1-6 & Section 1 SO 18355
	1	A, B, C	Alpine Energy Limited
RIGHT TO CONVEY TELECOMMUNICATIONS IN GROSS	4	D, E, F	Chorus NZ Limited
	1	A, B, C	

Building Platforms

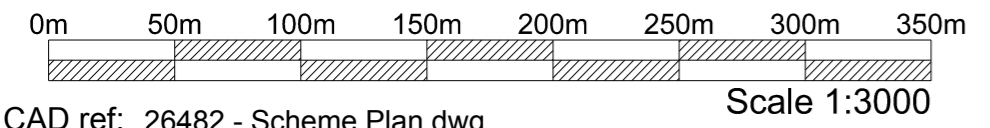

E	06/16	Amend 300m line	RB
issue	date	reason	approved

do
DAVIS OGILVIE
ENGINEERS SURVEYORS PLANNERS

Davis Ogilvie Ph. 03 366-1653
Engineers - Surveyors - Planners
11 Deans Avenue, Addington
Christchurch, New Zealand
P.O. Box 589 Christchurch 8140
OFFICES ALSO IN:
Nelson - Timaru - Greymouth

Proposed Subdivision of Lot 1 DP 422901

design	drawn	QA check	dwg	issue
CH/BL	BL	CH		
scale	date	file	302 E	
1:3000	06/16	26482		
@ A2				