

COMMERCIAL VEHICLE CROSSING

SCALE 1:20

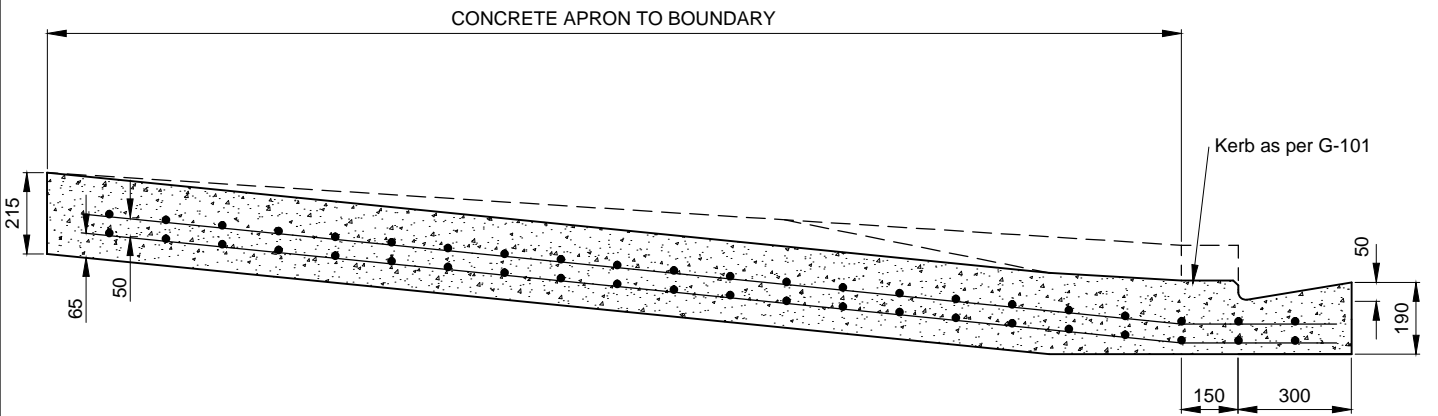

INDUSTRIAL VEHICLE CROSSING

SCALE 1:20

NOTES

1. Mesh to be 663 steel mesh
2. Concrete to be to NZS 3109 with 28 day strength = 30mpa
3. Basecourse under crossing and footpath to be 150mm AP40 M/4 compacted to TNZ B/2. Subbase to be 150mm AP65 with depth increased to ensure all deleterious material for 1.0m below the surface of the crossing has been removed.
4. Scala test subgrade to achieve a CBR of 7 minimum.

				TITLE:				ORIGINAL SCALE (A4): 1:20	
				COMMERCIAL & INDUSTRIAL CROSSING MID-SOUTH CANTERBURY ROADING COLLABORATION				DRAWING NUMBER:	
								G-104	
				SHEET: 1		OF: 1			
				B Issued for Construction		MAT GRP SWD 7/15		B	
				A Issued for Combined Maintenance Contract		MAT GRP SWD 7/15			
				REVISION		BY CHK APP DATE			