



design proposal

STRATHALLAN CORNER - TIMARU CBD PUBLIC FACILITIES

**rushton
architects**
planning | design | documentation | management

1 NGA MINO RANGA WHAKATAHI weaving threads together...

colonial heritage

The street face of the design acknowledges the Victorian /Edwardian architecture of Timarus' inner city.

The façade is complimented with a typical verandah further enhancing the streetscape connection.

Both ends of the façade extend past the building structure creating an open façade that pedestrians can easily move through to access the facilities while enhancing the streetscape.

indigenous heritage

As the building moves away from the street the building evolves into a less rigid form with the roof structure supported by a single column with cantilevered beams. This is shaped to evoke the silhouette of the Pouakai (Haast Eagle) as depicted in local rock art. The structure is anchored into the garden bed to further enhance the connection to nature.

As a concept, consultation on the most appropriate representation of this concept would be undertaken with local Iwi.



2 NGA WAHI HAUMARU safe design for urban spaces...

For safety, public spaces should be located along key pedestrian routes to enable more people coming through them.

The proposal allows for past and through pedestrian movements eliminating entrapment 'corners'.

The design maintains unobstructed view-lines from all directions ensuring no visual 'dead-spots'.

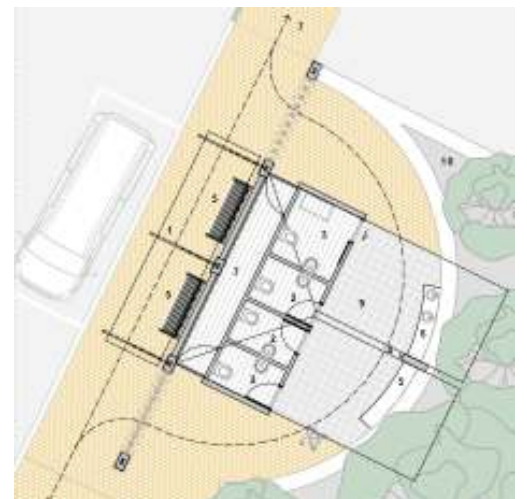



design proposal

STRATHALLAN CORNER - TIMARU CBD PUBLIC FACILITIES

**rushton
architects**
planning | design | documentation | management

3 TE ORANGA TONUTANGA sustainability...

storm-water harvesting

The roof structure is designed as an inverted hip. This allows storm-water from the roof to be harvested easily. This can be utilised for unit flushes and wash hand basins. When the storage system is at full capacity the overflow can be directed to the existing garden areas via overflows.

grey-water management

The greywater has the potential of being utilised by installing a small greywater recycling unit and used to 'feed' the adjacent garden areas.

solar energy

PV solar panels fitted to the roof will provide power generation to the grid of around 3kW on average. This is expected to be power positive given the expected occupancy use vs generation hours.

local materials + local trades

Utilising local materials such as bluestone cladding and paving, aggregates for concrete etc ensures the least whole of life embodied carbon.

Similarly, utilising local trades-people can minimize the embodied carbon.



4 WAAHI MAHA multi-purpose spaces...

Utilising a structure for more than one purpose gives greater cost effectiveness.

The proposal uses the 'heritage' styled façade and verandah as a repositioned bus stop and community information space. The location is ideal as the site is at the heart of the CBD and directly opposite the Community House.

